

# Aria Semi-Inset Square Basin

Product Code: **ARBSIW**



The Aria square semi-inset basin features an ultra thin edge & is designed to be partially installed into a vanity counter top. Combine with a basin mixer mounted on top of the basin. A chrome overflow takes any excess water back to the waste to prevent overflowing.

- AS/NZ Standard AS1172.4.2019
- Semi-inset basin
- Tap hole
- Overflow



## PRODUCT SPECIFICATIONS

Colour:	High gloss white
Material:	Superior vitreous china
Length:	400mm
Width:	400mm
Height:	155mm
Capacity:	4.5L
Basin Type:	Semi-inset
Net Weight:	10kg
Warranty:	10 years* (refer to decina.com.au)

## OPTIONAL ACCESSORIES

- ☒ 32 X 40mm Quattro pop-up basin waste - chrome **WA005**
- ☒ Overflow ring - PVD chrome **WA010**, brass matte black **WA011**

FRONT VIEW

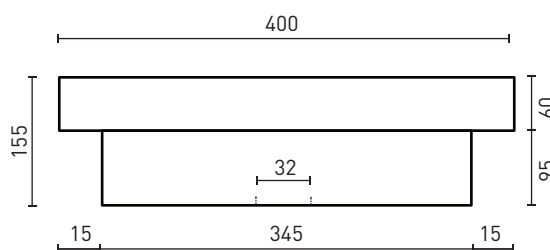

TOP VIEW

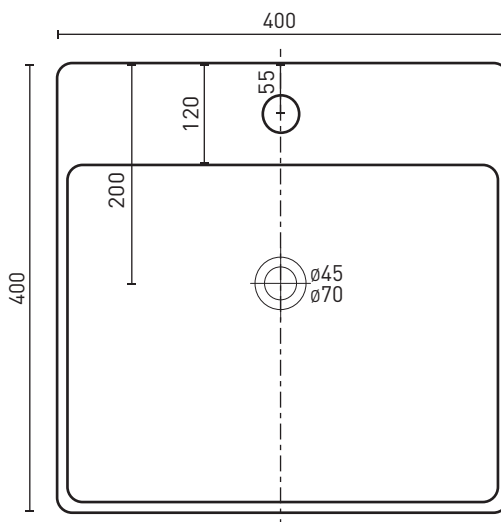

**DECINA**  
DISCOVER INDULGENCE

**DECINA.COM.AU** 1300 DECINA

\*Warranty T&Cs apply, visit [decina.com.au](https://decina.com.au) Decina reserves the right to change specifications without notice. Due to manufacturing tolerances dimensions may vary +/- 5mm. We recommend installation does not start until after delivery. Please confirm all particulars prior to purchase, call 1300 DECINA or visit [decina.com.au](https://decina.com.au)