

AVALON

Shower System

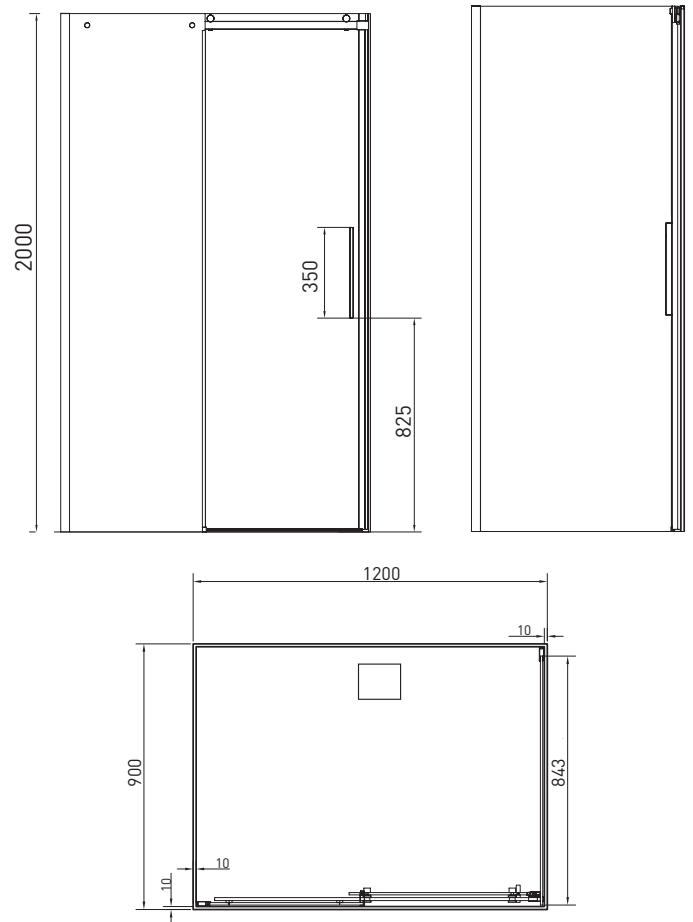

AVALON SHOWER SYSTEM

Featuring a premium, 8mm toughened glass, sliding door which glides effortlessly on a polished aluminium frame. The innovative rollers are designed with a square front and ideally suited in a modern, minimalist style bathroom. At two metres high and featuring a space saving sliding door, with a soft magnetic closing system, the Avalon is functional and stylish, perfect for upgrading any bathroom. The Avalon shower system comes with a Luna acrylic shower base and 2-sided acrylic wall, to create a leak resistant, low maintenance shower area.

SIZE (l)x(w)x(h)

- AVSYS1200R ~ 1200 x 900 x 2000 (mm)

NET WEIGHT

- 113.0 kg

KEY FEATURES

- Avalon shower screen
- Luna 1200 acrylic shower base
- 2-sided acrylic shower wall
- Square shaped roller cover design
- 8mm toughened safety glass
- Made to Australian Standards
- Reversible sliding doors can be installed for left or right hand entry
- Designed to fit straight onto a tiled floor
- Door rollers and brackets vigorously tested for strength and durability
- Easy to clean with exclusive EZI Clean coating
- Stainless steel roller
- Stainless steel interior/exterior handle

WARRANTY:

- Shower Screen - Five year warranty
 - Shower Wall - Five year warranty
 - Shower Base - Ten year warranty
- Conditions apply please see website for details