

3-SIDED 1000

Shower Wall

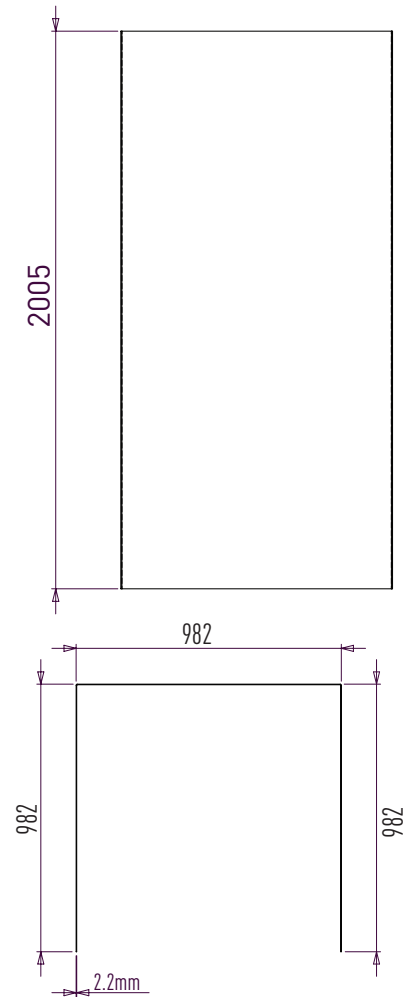

3-SIDED 1000 SHOWER WALL

Manufactured in Australia, Decina's shower walls are ideal for shower areas where easy maintenance is a priority. Decina's shower walls are made to Australian Standards from 2.0mm coextruded ABS acrylic and designed to reduce mould growth and the maintenance associated with grouting in a tiled shower area.

SIZE (l)x(w)x(d)x(h)

- SWAL1000 ~ 978 x 978 x 978 x 2005 (mm)

NET WEIGHT

- 11.0 kg

KEY FEATURES

- Made in Australia
- Made to Australian Standards
- Manufactured from 2.0mm coextruded ABS acrylic
- Reduces mould growth
- Creates a leak resistant membrane when combined with a Luna shower base
- Long-lasting durability
- Low maintenance
- Easy to clean

ACCESSORIES

- Shower Base

WARRANTY:

- Five year warranty -
Conditions apply please see website for details