

LUNA CURVED

Shower Base

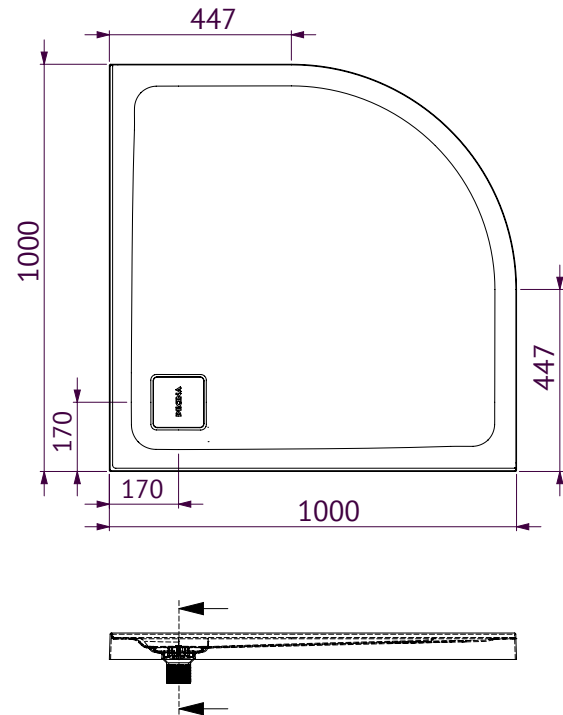

LUNA 1000 CURVED SHOWER BASE

Decina's slimline range of deluxe Luna shower bases are the latest in modern shower designs. The Luna curved shower base with a rear waste position, includes the exclusive high strength, chrome-plated, friction lock removable waste cover. Perfectly combined with the Lavano or Floriano curved shower screens, to create a low maintenance, leak resistant shower area.

SIZE (w)x(d)x(h)

- *SBCURVED* ~ 1000 x 1000 x 64* (mm)

*Base height to the top of the tile bead

NET WEIGHT

- 24.0 kg

WARRANTY:

- Ten year warranty -
Conditions apply please see website for details

KEY FEATURES

- 3-sided tile bead acrylic shower base
- Made in Australia
- Made to Australian Standards: AS3588/1996
- Rear waste outlet
- High strength, chrome-plated, friction lock removable square waste cover
- High-slip resistance
- Manufactured from premium sanitary grade acrylic
- High gloss white
- No mortar bed required
- Self-supporting feet for easy installation
- Steel rod reinforced base rim
- Base is reinforced with resin, timber board and fiberglass for extra strength
- Low maintenance & easy to clean
- Low entry height ~ 49mm
- Warm under foot
- Scratch, fade and stain resistant

ACCESSORIES

- 2-sided shower wall (*SW1000* ~ 983 x 983mm)
- Lavano curved shower screen (*LASSCURVED*)
- Floriano curved shower screen (*FLSSCURVED*)